

()
INTERSTATE COUNCIL FOR STANDARDIZATION, METROLOGY AND CERTIFICATION
(ISC)

IEC 60974-11- 2014

1 1

(IEC 60974-11:2010,)



2015

IEC 60974-11—2014

1.0—92 «
 1.2—2009 «
 1
 2 364 «
 3 29 2014 . No 69-)
 :

< 3166) 004-97	(3166) 004—97	
	8Y KG RU UA	-

4 2015 . No 498-CT (60974-11—2014 29 2016 .
 5 IEC 60974-11:2010 Arc welding equipment — Part 11: Electrode holders (11. -) . 26 « - (1) . () . - , , , - - (IDT)

6

IEC 60974-11—2014

1	1
2	1
3	1
4	2
5	2
5.1	2
5.2	2
6	2
7	3
8	3
8.1	3
8.2	3
8.3	4
9	4
9.1	4
9.2	5
9.3	5
10	5
10.1	5
10.2	5
10.3	6
10.4	6
11	7
12	7
()	8

Arc welding equipment. Part 11. Electrode holders

— 2016—01—01

1

10

2

(IEC 60050-151 International Electrotechnical Vocabulary —Part 151: Electrical and magnetic devices (IP])
IEC 60529 Degrees of protection provided by enclosures (IP Code) [
IEC 0974-1 Arc welding equipment — Part 1: Welding power sources (1.)

3

8 IEC 60050-151 IEC 60974-1.

3.1 (electrode holder):

3.2 (head):

3.3 (handle):

3.4 (level):

3.5 (rated current):
60 %

IEC 60974-11—2014

3.6 A (type A electrode holder):

IEC 60529.

3.7 (type 6 electrode holder):

(. 8.1).

4

- a) : 10 ° 40 ° :
- b) 50% 40 * ;
90% 20 ° .
20 ° 55 -

5

5.1

40 . 10 °
a) : 1; (± 1 %) ,

b) : ±2 .
5.2

- a) :
- b) , . 9.1:
- c) , . 10.4:
- d) , . 8.2:
- e) , . 8.3.

6

60 %

1.

1 —

60 %		
125	1.6 2.5	10 16
150	2 3.2	16 2S
200	2.5 4	25 35
250	3.2 5	35 SO

IEC 60974-11—2014

1

60 %		
300	4 6.3	50 70
400	5 8	70 9S
500	6.3 10	95 120
—		35 %.
600		

7

a)

b)

c)

d)

:

50

d).

8

8.1

a)

1)

2)

b)

1)

2)

6.3

d—

IEC 60529

12.5

! 60529

4 *o 0&

6.3

30 10 %.

8.2

)

pa /

91 % 95%.

20 ° 30 °

48

/ (/ 4) °

IEC 60974-11—2014

)

500

8.3

1000

1.45

50

60

1

1,4

9

9.1

1.

40

(. 1):

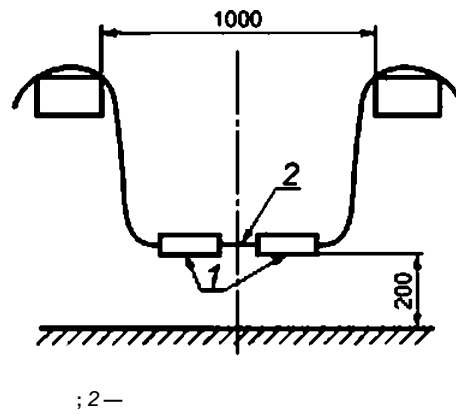
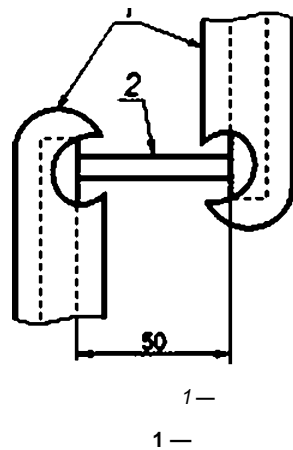

).

180°

(2

50

()

1 . .

200

60 %).

75 %

2 / ,

±2 %.

9.2

9.1

9.3

2.

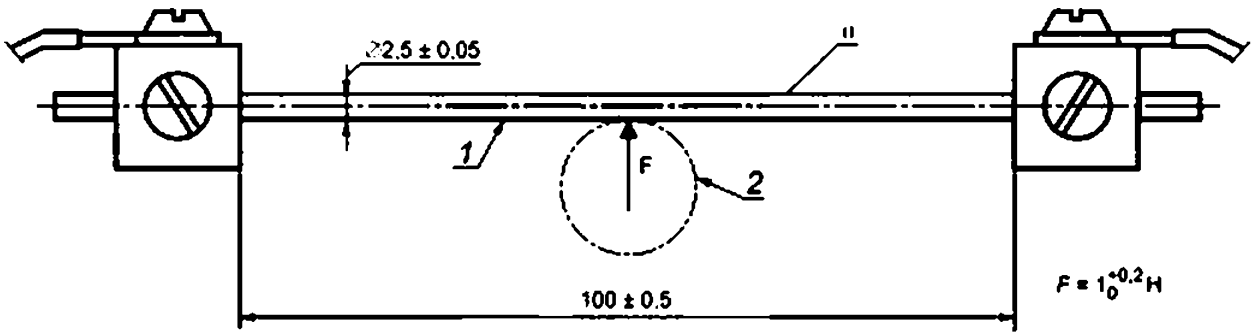

f— 16/8:2— ; 0—

2—

0 (25)
300,* °

2

10

10.1

10.2

30

S

IEC 60974-11—2014

10.3

40 2 2000 1

10.4

a)

1 9

b)

3. 40 * 40 * 5 1 400

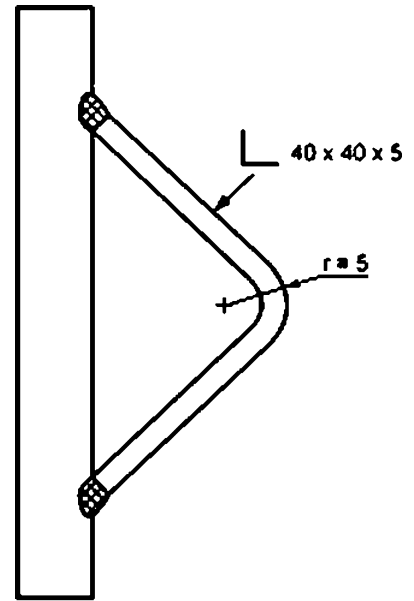
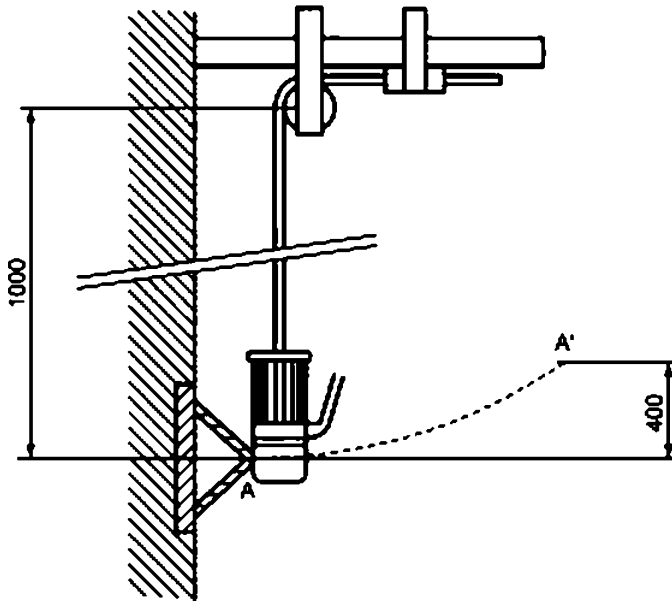

3—

11

- a)
- b)
- c)
- d)

STAR

200/IEC 60974-11

200

STAR, 8.

12

8

- a)
- b)
- c)
- d)
- e)

IEC 60974-11—2014

()

.1

IEC 60050-151 151.	- -	—
IEC 60529 (IP)	,	—
IEC 60974-1 1.	-	—
* . -		

621.791:006.354

25.160

: , , ,

.17

06.10.2015. 20.10.2015. 60«84/
. . .1.40. .< . .1.10. 34 . 3318.

< .123995 . .4
www.gos tin fo.ru infa@gostinfo.ru